

Hiroo pane place scale 1/100

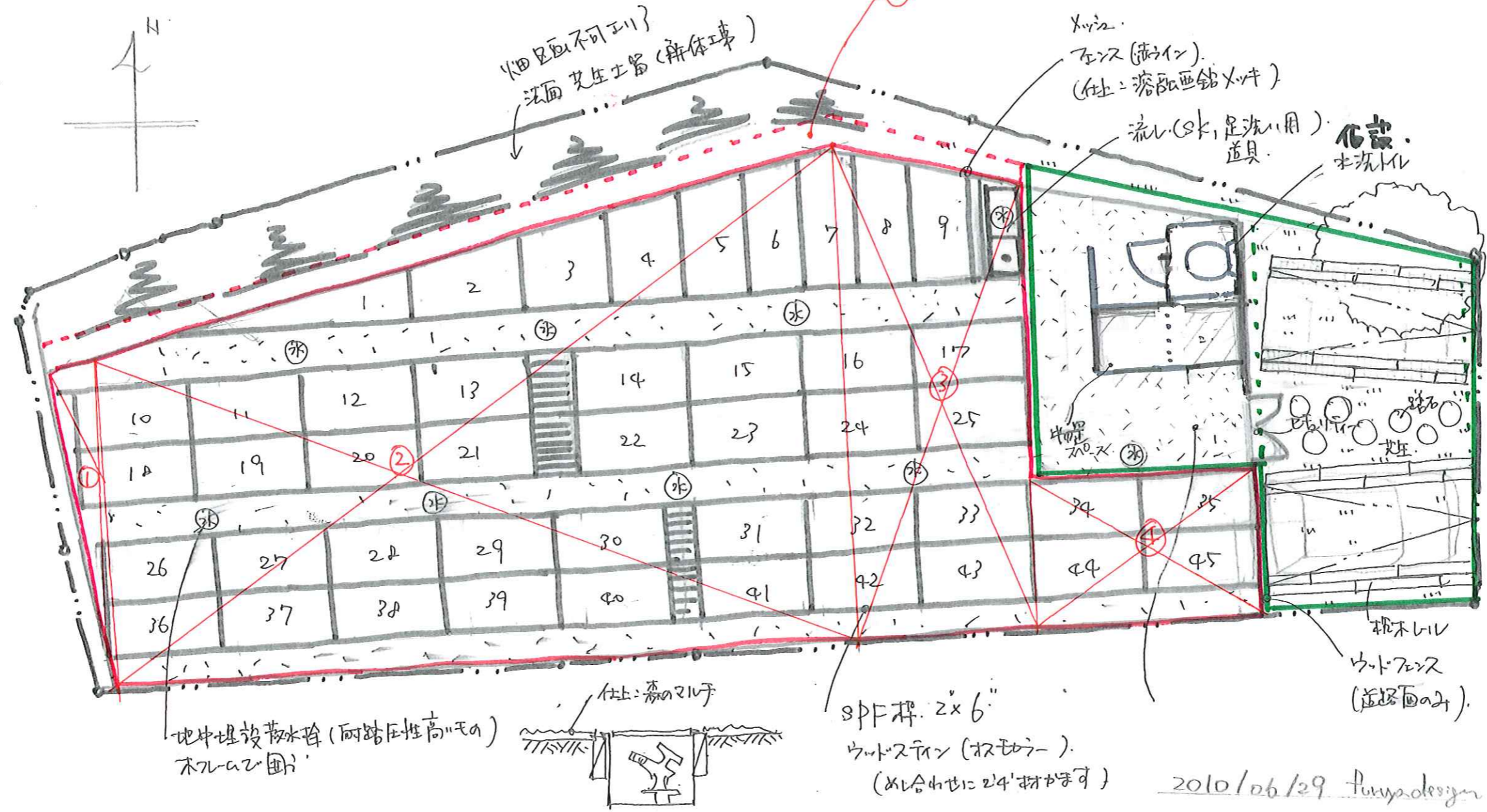

⑤ 傾斜部分  $(16.7 + 4) \times 0.6 \times 0.5 \times \frac{1}{2} = 3.1m^3$

石の追加計算

$$(6.5 + 5.2) \times 4.6 \times \frac{1}{2}$$

$$+ (8.2 + 7.0) \times 4.3 \times \frac{1}{2}$$

$$+ 2.0 \times 0.3 \times \frac{1}{2}$$

$$26.91 + 32.68 + 1.05$$

$$= 60.64 m^2$$

$$60.64 m^2 \times 0.5 m = 30.32 m^3$$

火田土所需面積

- ①  $1.0m \times 6.5m \times \frac{1}{2} = 3.25m^2$
- ②  $(10.1m + 6.5) \times 15.3 \times \frac{1}{2} = 127m^2$
- ③  $(10.1m + 9.1) \times 3.7 \times \frac{1}{2} = 35.5m^2$
- ④  $4.6 \times 3.1 = 14.26m^2$

合計

$$140m^2 \times 0.5m = 90m^3 + 3.1m^3$$

↳ 以外の石の追加 = 11